

11 フロック

2. 7. 31 分筆

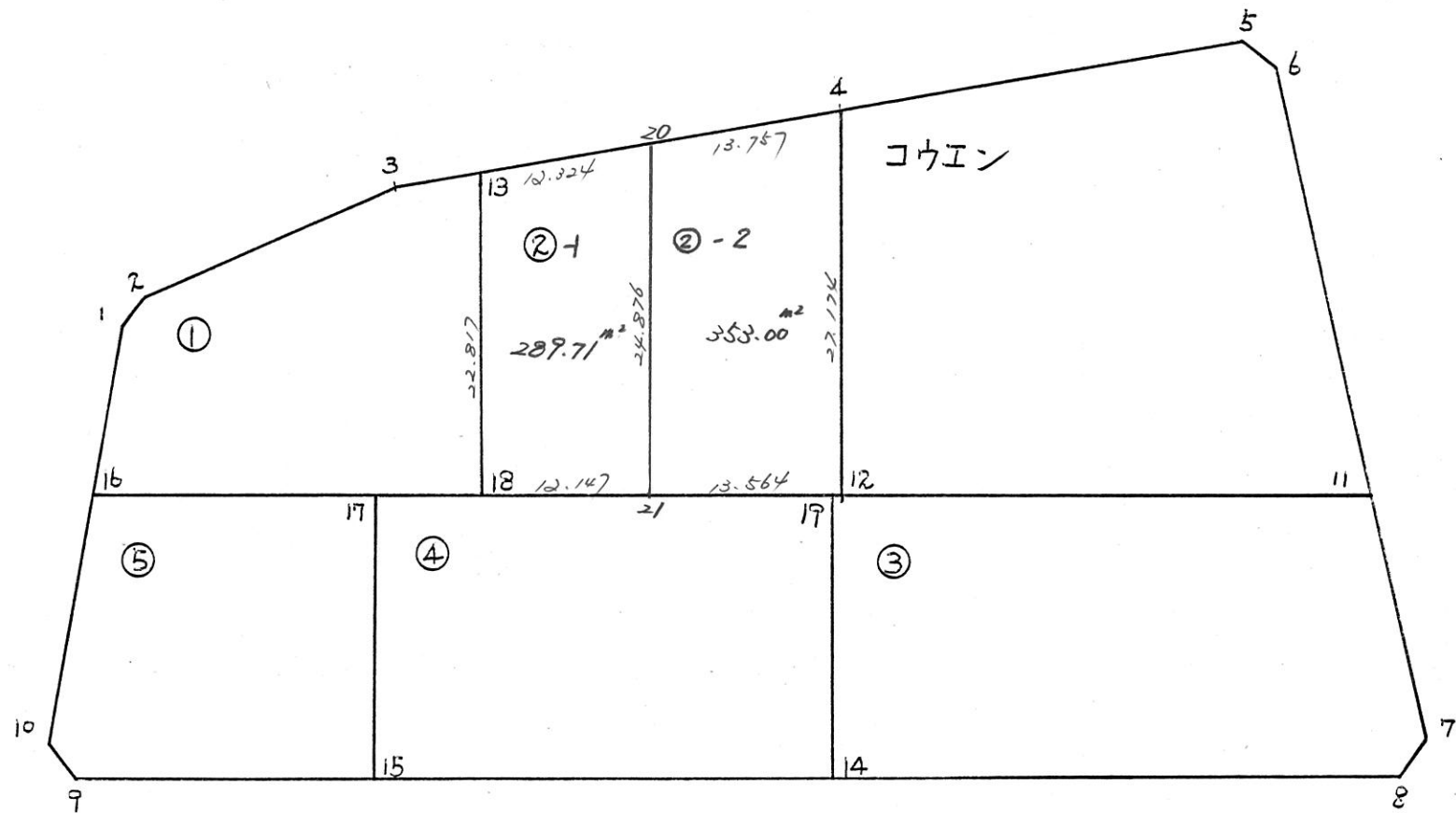

MENSEKI KEISAN

小寺1987番

T E N	11 BLOCK X	2-1 LOT DX	DMD.1	Y	DY	DMD.2	ALHA	DIST	DX * DMD.2	DY * DMD.1
13	-146704.384			-53497.166						
520	-146704.179	-0.205	-0.205	-53484.844	-12.322	-12.322	89-02-55	12.324	2.5260	2.5260
21	-146728.772	24.593	24.183	-53488.586	3.742	-20.902	188-39-08	24.876	-514.0428	90.4927
18	-146726.942	-1.830	46.946	-53500.594	12.008	-5.152	278-39-58	12.147	9.4281	563.7275
13	-146704.384	-22.558	22.558	-53497.166	-3.428	3.428	8-38-27	22.817	-77.3288	-77.3288
		24.593			15.750				11.9541	656.7463
		-24.593			-15.750				-591.3717	-77.3288
									579.4175	579.4175
									MENSEKI = 289.70	

$642.71m^2 - 353.01m^2 = 289.71m^2$ とす。

小寺1988番

T E N	11 BLOCK X	2-2 LOT DX	DMD.1	Y	DY	DMD.2	ALHA	DIST	DX * DMD.2	DY * DMD.1
20	-146704.179			-53484.844						
4	-146703.951	-0.228	-0.228	-53471.089	-13.755	-13.755	89-02-55	13.757	3.1361	3.1361
12	-146730.816	26.865	26.409	-53475.177	4.088	-23.422	188-39-08	27.174	-629.2320	107.9599
21	-146728.772	-2.044	51.230	-53488.586	13.409	-5.925	278-39-58	13.564	12.1107	686.9430
20	-146704.179	-24.593	24.593	-53484.844	-3.742	3.742	8-39-08	24.876	-92.0270	-92.0270
		26.865			17.497				15.2468	798.0392
		-26.865			-17.497				-721.2590	-92.0270
									706.0121	706.0121
									MENSEKI = 353.00	

MENSEKI KEISAN

T E N	11 BLOCK X	2-1 LOT DX	DMD.1	Y	DY	DMD.2	ALHA	DIST	DX * DMD.2	DY * DMD.1
13	-146704.384			-53497.166						
520	-146704.179	-0.205	-0.205	-53484.844	-12.322	-12.322	89-02-55	12.324	2.5260	2.5260
421	-146728.772	24.593	24.183	-53488.586	3.742	-20.902	188-39-08	24.876	-514.0428	90.4927
418	-146726.942	-1.830	46.946	-53500.594	12.008	-5.152	278-39-58	12.147	9.4281	563.7275
113	-146704.384	-22.558	22.558	-53497.166	-3.428	3.428	8-38-27	22.817	-77.3288	-77.3288
		24.593			15.750				11.9541	656.7463
		-24.593			-15.750				-591.3717	-77.3288
									579.4175	579.4175
									289.70	

MENSEKI =

$642.71m^2 - 363.0m^2 = 289.71m^2$ と 3.

T E N	11 BLOCK X	2-2 LOT DX	DMD.1	Y	DY	DMD.2	ALHA	DIST	DX * DMD.2	DY * DMD.1
520	-146704.179			-53484.844						
34	-146703.951	-0.228	-0.228	-53471.089	-13.755	-13.755	89-02-55	13.757	3.1361	3.1361
372	-146730.816	26.865	26.409	-53475.177	4.088	-23.422	188-39-08	27.174	-629.2320	107.9599
421	-146728.772	-2.044	51.230	-53488.586	13.409	-5.925	278-39-58	13.564	12.1107	686.9430
520	-146704.179	-24.593	24.593	-53484.844	-3.742	3.742	8-39-08	24.876	-92.0270	-92.0270
		26.865			17.497				15.2468	798.0392
		-26.865			-17.497				-721.2590	-92.0270
									706.0121	706.0121
									353.00	

MENSEKI =

* * * 線上計算書 * * * (11-3) - (11-4) NO 1

方向角 = 89-2-52 COS= +0.016619 SIN= +0.999862 修正率 = 0.9999390

点名	観測距離	修正距離	D X	X 配布	D Y	Y 配布	X	Y
11-3							-146715.496	- 53514.875
11-13	6.710	6.710	+ 0.112	+ 0	+ 6.709	+ 0	-146715.384	- 53508.166
11-4	26.083	26.081	+ 0.433	+ 0	+ 26.077	+ 0	-146714.951	- 53482.089
合計 =	32.793	32.791	+ 0.545	+ 0	+ 32.786	+ 0	+ 0.545	+ 32.786

* * * 線上計算書 * * * (11-8) - (11-9) NO 2

方向角 = 278-39-41 COS= +0.150595 SIN= -0.988596 修正率 = 0.9999682

点名	観測距離	修正距離	D X	X 配布	D Y	Y 配布	X	Y
11-8							-146767.556	- 53449.967
11-14	40.434	40.433	+ 6.089	+ 0	- 39.972	+ 0	-146761.467	- 53489.939
11-15	32.615	32.614	+ 4.911	+ 1	- 32.242	+ 0	-146756.555	- 53522.181
11-9	21.333	21.332	+ 3.212	+ 0	- 21.089	+ 0	-146753.343	- 53543.270
合計 =	94.382	94.379	+ 14.212	+ 1	- 93.303	+ 0	+ 14.213	- 93.303

* * * 線上計算書 * * * (11-10) - (11-1) NO 3

方向角 = 19-7-56 COS= +0.944765 SIN= +0.327749 修正率 = 1.0000658

点名	観測距離	修正距離	D X	X 配布	D Y	Y 配布	X	Y
11-10							-146750.769	- 53544.794
11-16	17.981	17.982	+ 16.989	+ 0	+ 5.894	+ 0	-146733.780	- 53538.900
11-1	12.418	12.419	+ 11.733	+ 0	+ 4.070	+ 0	-146722.047	- 53534.830
合計 =	30.399	30.401	+ 28.722	+ 0	+ 9.964	+ 0	+ 28.722	+ 9.964

* * * 線上計算書 * * * (11-12) - (11-16) NO 4

方向角 = 278-39-59 COS= +0.150681 SIN= -0.988582 修正率 = 1.0000000

点名	観測距離	修正距離	D X	X 配布	D Y	Y 配布	X	Y
11-12							-146741.816	- 53486.177
11-19	0.762	0.762	+ 0.115	+ 0	- 0.753	+ 0	-146741.701	- 53486.930
11-18	24.949	24.949	+ 3.759	+ 0	- 24.664	+ 0	-146737.942	- 53511.594
11-17	7.668	7.668	+ 1.155	+ 0	- 7.580	- 1	-146736.787	- 53519.175
11-16	19.953	19.953	+ 3.007	+ 0	- 19.725	+ 0	-146733.780	- 53538.900

$$\text{合計} = 53.332 \quad 53.332 \quad + \quad 8.036 \quad + \quad 0 \quad - \quad 52.722 \quad - \quad 1 \quad + \quad 8.036 \quad - \quad 52.723$$

* * * 方向角 · 距離 計算書 * * *

NO 1			NO 2			NO 3		
点名	X	Y	点名	X	Y	点名	X	Y
1 11-12	- 146741.816	- 53486.177	1 11-13	- 146715.384	- 53508.166	1 11-14	- 146761.467	- 53489.939
2 11-16	- 146733.780	- 53538.900	2 11-18	- 146737.942	- 53511.594	2 11-19	- 146741.701	- 53486.930
COS=+ 0.150679 SIN=- 0.988583			COS=- 0.988650 SIN=- 0.150239			COS=+ 0.988610 SIN=+ 0.150497		
A L= 278-39-59 L = 53.332			A L= 188-38-27 L = 22.817			A L= 8-39-21 L = 19.994		

NO 4		
点名	X	Y
1 11-15	- 146756.555	- 53522.181
2 11-17	- 146736.787	- 53519.175
COS=+ 0.988635 SIN=+ 0.150336		
A L= 8-38-47 L = 19.995		

* * * * * 各 筆 面 積 計 算 書 * * * * *

11 BLOCK

点 名	X	Y	(X-X0)*(YN-1-Y0)	(XN-1-X0)*(Y-Y0)
X0·Y0	- 146700.000	- 53400.000		
11-1	- 146722.047	- 53534.830		
11-2	- 146720.002	- 53532.630	+ 2696.869660	+ 2924.093610
11-3	- 146715.496	- 53514.875	+ 2055.234480	+ 2297.729750
11-4	- 146714.951	- 53482.089	+ 1717.496125	+ 1272.051144
11-5	- 146714.487	- 53453.146	+ 1189.223343	+ 794.585846
11-6	- 146716.508	- 53450.940	+ 877.334168	+ 737.967780
11-7	- 146765.549	- 53447.732	+ 3339.066060	+ 787.959856
11-8	- 146767.556	- 53449.967	+ 3224.582992	+ 3275.286883
11-9	- 146753.343	- 53543.270	+ 2665.389681	+ 9678.748120
11-10	- 146750.769	- 53544.794	+ 7273.674630	+ 7723.746342
11-1	- 146722.047	- 53534.830	+ 3192.273318	+ 6845.184270
			+ 28231.144457	+ 36337.353601
		倍面積	= 8106.209144	
		面積	= 4053.104572	

1 LOT

小寺1986番

点 名	X	Y	(X-X0)*(YN-1-Y0)	(XN-1-X0)*(Y-Y0)
X0·Y0	- 146700.000	- 53500.000		
11-16	- 146733.780	- 53538.900		
11-1	- 146722.047	- 53534.830	+ 857.628300	+ 1176.557400
11-2	- 146720.002	- 53532.630	+ 696.669660	+ 719.393610
11-3	- 146715.496	- 53514.875	+ 505.634480	+ 297.529750
11-13	- 146715.384	- 53508.166	+ 228.837000	+ 126.540336
11-18	- 146737.942	- 53511.594	+ 309.834372	+ 178.362096
11-16	- 146733.780	- 53538.900	+ 391.645320	+ 1475.943800
			+ 2990.249132	+ 3974.326992
		倍面積	= 984.077860	
		面積	= 492.038930	

2 LOT

点 名	X	Y	(X-X0)*(YN-1-Y0)	(XN-1-X0)*(Y-Y0)
X0·Y0	- 146700.000	- 53400.000		
11-13	- 146715.384	- 53508.166		
11-4	- 146714.951	- 53482.089	+ 1617.189866	+ 1262.857176
11-12	- 146741.816	- 53486.177	+ 3432.633624	+ 1288.432327
11-18	- 146737.942	- 53511.594	+ 3269.727734	+ 4666.414704
11-13	- 146715.384	- 53508.166	+ 1716.762096	+ 4104.034372
			+ 10036.313320	+ 11321.738579
		倍面積	= 1285.425259	
		面積	= 642.712629	

2-1, 2-2 = 分割

* * * * * 各 筆 面 積 計 算 書 * * * * *

3 LOT 小寺1990番

点 名	X	Y	(X-X0)*(YN-1-Y0)	(XN-1-X0)*(Y-Y0)
X0-Y0	- 146700.000	- 53400.000		
11-11	- 146747.494	- 53448.913		
11-7	- 146765.549	- 53447.732	+ 3206.198237	+ 2266.983608
11-8	- 146767.556	- 53449.967	+ 3224.582992	+ 3275.286883
11-14	- 146761.467	- 53489.939	+ 3071.321589	+ 6075.919084
11-19	- 146741.701	- 53486.930	+ 3750.546239	+ 5343.326310
11-12	- 146741.816	- 53486.177	+ 3635.064880	+ 3593.667077
11-11	- 146747.494	- 53448.913	+ 4092.890438	+ 2045.346008
			+ 20980.604375	+ 22600.528970
		倍面積	= 1619.924595	
		面積	= 809.962297	

4 LOT 小寺1991番

点 名	X	Y	(X-X0)*(YN-1-Y0)	(XN-1-X0)*(Y-Y0)
X0-Y0	- 146700.000	- 53400.000		
11-14	- 146761.467	- 53489.939		
11-15	- 146756.555	- 53522.181	+ 5086.500145	+ 7510.099527
11-17	- 146736.787	- 53519.175	+ 4494.672447	+ 6739.942125
11-19	- 146741.701	- 53486.930	+ 4969.716675	+ 3197.893910
11-14	- 146761.467	- 53489.939	+ 5343.326310	+ 3750.546239
			+ 19894.215577	+ 21198.481801
		倍面積	= 1304.266224	
		面積	= 652.133112	

5 LOT 小寺1992番

点 名	X	Y	(X-X0)*(YN-1-Y0)	(XN-1-X0)*(Y-Y0)
X0-Y0	- 146700.000	- 53500.000		
11-15	- 146756.555	- 53522.181		
11-9	- 146753.343	- 53543.270	+ 1183.201083	+ 2447.134850
11-10	- 146750.769	- 53544.794	+ 2196.774630	+ 2389.446342
11-16	- 146733.780	- 53538.900	+ 1513.141320	+ 1974.914100
11-17	- 146736.787	- 53519.175	+ 1431.014300	+ 647.731500
11-15	- 146756.555	- 53522.181	+ 1084.442125	+ 815.972447
			+ 7408.573458	+ 8275.199239
		倍面積	= 866.625781	
		面積	= 433.312890	

コウエン

点 名	X	Y	(X-X0)*(YN-1-Y0)	(XN-1-X0)*(Y-Y0)
X0-Y0	- 146700.000	- 53400.000		
11-4	- 146714.951	- 53482.089		
11-5	- 146714.487	- 53453.146	+ 1189.223343	+ 794.585846

* * * * * 各 筆 面 積 計 算 書 * * * * *

点 名	X	Y	(X-X0)*(YN-1-Y0)	(XN-1-X0)*(Y-Y0)
11-6	- 146716.508	- 53450.940	+ 877.334168	+ 737.967780
11-11	- 146747.494	- 53448.913	+ 2419.344360	+ 807.455804
11-12	- 146741.816	- 53486.177	+ 2045.346008	+ 4092.890438
11-4	- 146714.951	- 53482.089	+ 1288.432327	+ 3432.633624
			+ 7819.680206	+ 9865.533492
		倍面積	= 2045.853286	
		面積	= 1022.926643	

* * * 各筆面積 集計表 * * *

街区名・筆名	各筆面積	隅切面積
11 BLOCK	4053.10	
1 LOT	492.03	
2 LOT	642.71	
3 LOT	809.96	
4 LOT	652.13	
5 LOT	433.31	
コウエン	1022.92	
合計 =	4053.06	0.00