

S11	5.436
S12	1.451
S13	1.848
S14	1.479
S15	1.517
S16	2.718
S17	2.718

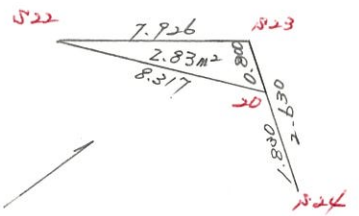

マウチ ケイサ

TONO. 23 -- TONO. 24

ALH= 157-40-36

COS= -0.925055

SIN= 0.379833

TONO.	キヨリ	DX	ハイ	DY	ハイ	X	Y	シヨクイ キヨ
23						-146611.344	-53446.936	
1	0.800	-0.740	0	0.304	0	-146612.084	-53446.632	0.800
24	1.830	-1.693	0	0.695	0	-146613.777	-53445.937	1.830
ゴウケイ	2.630	-2.433	0	0.999	0	-2.433	0.999	

\* \* \* \* \*

キマウ ケイサ

TONO. 22	TONO. 1	DX =	DY =	COS=	SIN=	ALHA=	DIST=
X -146610.732	-146612.084	-1.352	8.206	-0.162566	0.986698	99-21-21	8.317
Y -53454.838	-53446.632						

\* \* \* \* \*

\* \* マウチ ケイサ \*

PAGE 03

6-3 LOT

TONO.	X	Y	(X-X <sub>0</sub> ) (Y <sub>N-1</sub> -Y <sub>0</sub> )	(X <sub>N-1</sub> -X <sub>0</sub> ) (Y-Y <sub>0</sub> )
X <sub>0</sub> Y <sub>0</sub>	-146600.000	-53400.000		
22	-146610.732	-53454.838		
23	-146611.344	-53446.936	622.082272	503.717152
1	-146612.084	-53446.632	567.174624	528.993408
22	-146610.732	-53454.838	500.454624	662.662392
			1689.711520	1695.372952
			ハイキキ=	5.661432
			ズキキ=	2.830716

\*\*\*\*\*

ガイク	ムセキ=	0.000000
ガクヒツソウムセキ=		2.830716
スミキリソウムセキ=		0.000000

\*\*\*\*\*

6-3 LOT

テリNO.	X	Y	(X-X <sub>0</sub> )(Y <sub>N-1</sub> -Y <sub>0</sub> )	(X <sub>N-1</sub> -X <sub>0</sub> )(Y-Y <sub>0</sub> )
X <sub>0</sub> Y <sub>0</sub>	-146600.000	-53400.000		
8 22	-146610.732	-53454.838		
8 23	-146611.344	-53446.936	622.082272	503.717152
20	-146612.084	-53446.632	567.174624	528.993408
8 22	-146610.732	-53454.838	500.454624	662.662392
			1689.711520	1695.372952
			ハイマセキ=	5.661432
			マセキ=	2.830716

マクチ ケイサシ

テリNO. 23 -- テリNO. 24

ALH= 157-40-36

COS= -0.925055

SIN= 0.379833

テリNO.	キヨリ	DX	ハイ	DY	ハイ	X	Y	シユセイ キヨリ
23						-146611.344	-53446.936	
1	0.800	-0.740	0	0.304	0	-146612.084	-53446.632	0.800
24	1.830	-1.693	0	0.695	0	-146613.777	-53445.937	1.830
ゴウケイ=	2.630	-2.433	0	0.999	0	-2.433	0.999	

\* \* \* \* \*

キマク ケイサシ

	テリNO. 22	テリNO. 1	DX =	DY =	COS=	SIN=	ALHA=	DIST=
X	-146610.732	-146612.084	-1.352	8.206	-0.162566	0.986698	99-21-21	8.317
Y	-53454.838	-53446.632						

\* \* \* \* \*

\* \* メンセキケイサシ \* \*

PAGE 03

6-3 LOT

テリNO.	X	Y	(X-X <sub>o</sub> ) (YN-1-Y <sub>o</sub> )	(XN-1-X <sub>o</sub> ) (Y-Y <sub>o</sub> )
X <sub>o</sub> Y <sub>o</sub>	-146600.000	-53400.000		
22	-146610.732	-53454.838		
23	-146611.344	-53446.936	622.082272	503.717152
1	-146612.084	-53446.632	567.174624	528.993408
22	-146610.732	-53454.838	500.454624	662.662392

1689.711520

1695.372952

ハノイノヤキニ

5.661437

6-3 LOT

テリNO. X。Y。	X	Y	(X-X。)(YN-1-Y。)	(XN-1-X。)(Y-Y。)
	-146600.000	-53400.000		
22	-146610.732	-53454.838		
23	-146611.344	-53446.936	622.082272	503.717152
1	-146612.084	-53446.632	567.174624	528.993408
22	-146610.732	-53454.838	500.454624	662.662392
			1689.711520	1695.372952
			ハイメキ=	5.661432
			メキ=	2.830716



\* \* \* 突出し計算書 \* \* \*

NO.	1	2
視準点名	MKB41	MKB43
観測点名	MKB42	MKB42
求点名	6-9	6-11
方向角 1	5-17-36	78-43-51
観測角	62-26-55	8- 5-55
方向角 2	67-44-31	86-49-46
距離	9.010	13.492
COS & SIN	+ 0.378779 + 0.925487	+ 0.055308 + 0.998469
X 1 . Y 1 =	-146619.223 - 53498.073	-146619.223 - 53498.073
DX . DY =	+ 3.413 + 8.339	+ 0.746 + 13.471
X 2 . Y 2 =	-146615.810 - 53489.734	-146618.477 - 53484.602

\* \* \* 線上計算書 \* \* \* (6-1) - (6-2) NO 1

方向角 = 264-50-10 COS= -0.090005 SIN= -0.995941 修正率 = 1.0000448

点名	観測距離	修正距離	D X	X 配布	D Y	Y 配布	X	Y
6-1							-146645.039	- 53438.527
6-13	14.843	14.844	- 1.336	+ 0	- 14.784	+ 0	-146646.375	- 53453.311
6-2	29.798	29.799	- 2.682	+ 0	- 29.678	+ 0	-146649.057	- 53482.989
合計 =	44.641	44.643	- 4.018	+ 0	- 44.462	+ 0	- 4.018	- 44.462

\* \* \* 線上計算書 \* \* \* (6-3) - (6-4) NO 2

方向角 = 357-37-28 COS= +0.999141 SIN= -0.041449 修正率 = 1.0001045

点名	観測距離	修正距離	D X	X 配布	D Y	Y 配布	X	Y
6-3							-146647.068	- 53485.232
6-12	26.144	26.147	+ 26.125	- 1	- 1.084	+ 0	-146620.944	- 53486.316
6-4	2.563	2.563	+ 2.561	+ 0	- 0.106	+ 0	-146618.383	- 53486.422
合計 =	28.707	28.710	+ 28.686	- 1	- 1.190	+ 0	+ 28.685	- 1.190

\* \* \* 線上計算書 \* \* \* (6-4) - (6-5) NO 3

方向角 = 293-36-45 COS= +0.400549 SIN= -0.916275 修正率 = 1.0000321

点名	観測距離	修正距離	D X	X 配布	D Y	Y 配布	X	Y
6-4							-146618.383	- 53486.422
6-8	6.906	6.906	+ 2.766	+ 0	- 6.328	+ 0	-146615.617	- 53492.750
6-14	12.076	12.077	+ 4.837	+ 1	- 11.066	+ 0	-146610.779	- 53503.816
6-5	12.134	12.134	+ 4.860	+ 0	- 11.118	+ 0	-146605.919	- 53514.934
合計 =	31.116	31.117	+ 12.463	+ 1	- 28.512	+ 0	+ 12.464	- 28.512

\* \* \* 線上計算書 \* \* \* (S4) - (S5) NO 4

方向角 = 118-55-42 COS= -0.483715 SIN= +0.875225 修正率 = 1.0000000

点名	観測距離	修正距離	D X	X 配布	D Y	Y 配布	X	Y
S4							-146579.290	- 53503.948
6-15	0.630	0.630	- 0.305	+ 0	+ 0.551	+ 0	-146579.595	- 53503.397
S5	3.339	3.339	- 1.615	+ 0	+ 2.922	+ 1	-146581.210	- 53500.474
合計 =	3.969	3.969	- 1.920	+ 0	+ 3.473	+ 1	- 1.920	+ 3.474

\* \* \* 線上計算書 \* \* \* (S7) - (S8) NO 5

方向角 = 150-44-18 COS= -0.872396 SIN= +0.488799 修正率 = 1.0016464

点名	観測距離	修正距離	D X	X 配布	D Y	Y 配布	X	Y
S7							-146585.475	- 53496.699
6-16	4.569	4.577	- 3.993	+ 0 +	2.237	+ 0	-146589.468	- 53494.462
S8	0.290	0.290	- 0.253	+ 0 +	0.142	+ 0	-146589.721	- 53494.320
合計 =	4.859	4.867	- 4.246	+ 0 +	2.379	+ 0	- 4.246	+ 2.379

\* \* \* 線上計算書 \* \* \* (S12) - (S13) NO 6

方向角 = 164-31-36 COS= -0.963755 SIN= +0.266790 修正率 = 1.0000000

点名	観測距離	修正距離	D X	X 配布	D Y	Y 配布	X	Y
S12							-146613.905	- 53486.313
6-10	0.825	0.825	- 0.795	+ 0 +	0.220	+ 0	-146614.700	- 53486.093
S13	0.626	0.626	- 0.603	+ 0 +	0.167	+ 0	-146615.303	- 53485.926
合計 =	1.451	1.451	- 1.398	+ 0 +	0.387	+ 0	- 1.398	+ 0.387

\* \* \* 線上計算書 \* \* \* (S21) - (S22) NO 7

方向角 = 81-51-50 COS= +0.141525 SIN= +0.989935 修正率 = 1.0000000

点名	観測距離	修正距離	D X	X 配布	D Y	Y 配布	X	Y
S21							-146611.120	- 53457.552
6-17	1.053	1.053	+ 0.149	+ 0 +	1.042	+ 0	-146610.971	- 53456.510
S22	1.689	1.689	+ 0.239	+ 0 +	1.672	+ 0	-146610.732	- 53454.838
合計 =	2.742	2.742	+ 0.388	+ 0 +	2.714	+ 0	+ 0.388	+ 2.714

\* \* \* 線 上 計 算 書 \* \* \* (6-13 ) - (6-17 ) N O 1

方向角 = 354-50-13    COS = +0.995943    SIN = -0.089990    修正率 = 1.0000000

点 名	観測距離	修正距離	D X	X 配布	D Y	Y 配布	X	Y
6-13							-146646.375	- 53453.311
6-18	15.385	15.385	+ 15.323	+ 0	- 1.385	+ 0	-146631.052	- 53454.696
6-17	20.163	20.163	+ 20.081	+ 0	- 1.814	+ 0	-146610.971	- 53456.510
合計 =	35.548	35.548	+ 35.404	+ 0	- 3.199	+ 0	+ 35.404	- 3.199

\* \* \* 方向角 · 距離 計 算 書 \* \* \*

NO 1			NO 2			NO 3		
点名	X	Y	点名	X	Y	点名	X	Y
1 6-13	- 146646.375	- 53453.311	1 6-12	- 146620.944	- 53486.316	1 6-11	- 146618.477	- 53484.602
2 6-17	- 146610.971	- 53456.510	2 6-11	- 146618.477	- 53484.602	2 S16	- 146618.315	- 53484.112
COS=+ 0.995943 SIN=- 0.089990			COS=+ 0.821244 SIN=+ 0.570577			COS=+ 0.313902 SIN=+ 0.949456		
A L= 354-50-13 L = 35.548			A L= 34-47-26 L = 3.004			A L= 71-42-20 L = 0.516		

NO 4			NO 5			NO 6		
点名	X	Y	点名	X	Y	点名	X	Y
1 6-8	- 146615.617	- 53492.750	1 6-9	- 146615.810	- 53489.734	1 6-14	- 146610.779	- 53503.816
2 6-9	- 146615.810	- 53489.734	2 6-10	- 146614.700	- 53486.093	2 6-16	- 146589.468	- 53494.462
COS=- 0.063861 SIN=+ 0.997959			COS=+ 0.291611 SIN=+ 0.956537			COS=+ 0.915676 SIN=+ 0.401916		
A L= 93-39-41 L = 3.022			A L= 73- 2-44 L = 3.806			A L= 23-41-53 L = 23.274		

NO 7		
点名	X	Y
1 6-5	- 146605.919	- 53514.934
2 6-15	- 146579.595	- 53503.397
COS=+ 0.915898 SIN=+ 0.401410		
A L= 23-39-59 L = 28.741		

\* \* \* \* \* 2 直 線 の 交 点 計 算 書 \* \* \* \* \*

求 点 名            N O    1   6-19

ALH T1.T2	84-50-13	346- 9-40
SIN T1.T2	+0.995943	-0.239193
COS T1.T2	+0.089990	+0.970972

コソカク = T            98-40-33  
COSEC T    +    1.011575

	X		Y
1 6-18	- 146631.052	-	53454.696
2 S25	- 146645.026	-	53438.175
X1-2.Y2-1	+    13.974	+	16.521

X1-2*SI1.2	+    13.9173	-	3.3425
Y2-1*CO1.2	+     1.4867	+	16.0414
COSEC*S1.2	+    15.5823	+	12.8459

キヨリ S1.S2            12.846            15.582

	X		Y
1 6-18	- 146631.052	-	53454.696
DX DY	+     1.156	+	12.794
3 6-19	- 146629.896	-	53441.902

\* \* \* \* \* 各 筆 面 積 計 算 書 \* \* \* \* \*

6 BLOCK

点 名	X	Y	(X-X0)*(YN-1-Y0)	(XN-1-X0)*(Y-Y0)
X0・Y0	- 146500.000	- 53400.000		
6-1	- 146645.039	- 53438.527		
6-2	- 146649.057	- 53482.989	+ 5742.719039	+ 12036.641571
6-3	- 146647.068	- 53485.232	+ 12205.026252	+ 12704.426224
6-4	- 146618.383	- 53486.422	+ 10090.019856	+ 12709.910696
6-5	- 146605.919	- 53514.934	+ 9153.731818	+ 13606.231722
6-6	- 146598.410	- 53532.051	+ 11310.654940	+ 13986.709869
6-7	- 146574.941	- 53521.762	+ 9896.033991	+ 11982.598420
S1	- 146575.928	- 53519.359	+ 9245.145136	+ 8944.882819
S2	- 146575.319	- 53514.129	+ 8990.000521	+ 8665.586712
S3	- 146577.992	- 53507.367	+ 8901.148968	+ 8086.775073
S4	- 146579.290	- 53503.948	+ 8513.129430	+ 8107.112416
S5	- 146581.210	- 53500.474	+ 8441.617080	+ 7966.583460
S6	- 146581.723	- 53499.696	+ 8211.036702	+ 8096.312160
S7	- 146585.475	- 53496.699	+ 8521.515600	+ 7902.532377
S8	- 146589.721	- 53494.320	+ 8675.930979	+ 8062.002000
S9	- 146596.141	- 53492.162	+ 9068.019120	+ 8268.866802
S10	- 146598.825	- 53491.088	+ 9107.909650	+ 8757.291408
S11	- 146608.713	- 53487.925	+ 9902.449744	+ 8689.188125
S12	- 146613.905	- 53486.313	+ 10015.097125	+ 9383.345169
S13	- 146615.303	- 53485.926	+ 9952.147839	+ 9787.401030
S14	- 146617.148	- 53486.030	+ 10066.059048	+ 9919.517090
S15	- 146618.565	- 53485.608	+ 10200.146950	+ 10028.805984
S16	- 146618.315	- 53484.112	+ 10128.710520	+ 9972.739280
S17	- 146617.477	- 53481.526	+ 9881.225424	+ 9645.748690
S18	- 146613.818	- 53469.695	+ 9279.126268	+ 8187.559515
S19	- 146612.786	- 53465.993	+ 7860.620270	+ 7511.191274
S20	- 146611.639	- 53460.940	+ 7367.392527	+ 6873.178840
S21	- 146611.120	- 53457.552	+ 6771.652800	+ 6425.047728
S22	- 146610.732	- 53454.838	+ 6372.848064	+ 6093.598560
S23	- 146611.344	- 53446.936	+ 6105.882272	+ 5197.317152
S24	- 146613.777	- 53445.937	+ 5340.237272	+ 5114.809328
S24-1	- 146615.902	- 53445.251	+ 5324.190174	+ 5148.523027
S24-2	- 146621.591	- 53443.948	+ 5502.114341	+ 5093.661096
S25	- 146645.026	- 53438.175	+ 6373.602648	+ 4641.736425
6-1	- 146645.039	- 53438.527	+ 5536.863825	+ 5587.416702
			+288054.006193	+293185.248744
		倍面積	= 5131.242551	
		面積	= 2565.621275	

1 LOT

門田1208番

点 名	X	Y	(X-X0)*(YN-1-Y0)	(XN-1-X0)*(Y-Y0)
X0・Y0	- 146500.000	- 53500.000		
6-5	- 146605.919	- 53514.934		
6-6	- 146598.410	- 53532.051	+ 1469.654940	+ 3394.809869

\* \* \* \* \* 各 筆 面 積 計 算 書 \* \* \* \* \*

点 名	X	Y	(X-X0)*(YN-1-Y0)	(XN-1-X0)*(Y-Y0)
6-7	- 146574.941	- 53521.762	+ 2401.933991	+ 2141.598420
S1	- 146575.928	- 53519.359	+ 1652.345136	+ 1450.782819
S2	- 146575.319	- 53514.129	+ 1458.100521	+ 1072.786712
S3	- 146577.992	- 53507.367	+ 1101.948968	+ 554.875073
S4	- 146579.290	- 53503.948	+ 584.129430	+ 307.912416
6-15	- 146579.595	- 53503.397	+ 314.241060	+ 269.348130
6-5	- 146605.919	- 53514.934	+ 359.806843	+ 1188.671730
			+ 9342.160889	+ 10380.785169
		倍面積	= 1038.624280	
		面積	= 519.312140	

2 LOT

門田1209番

点 名	X	Y	(X-X0)*(YN-1-Y0)	(XN-1-X0)*(Y-Y0)
X0・Y0	- 146500.000	- 53400.000		
6-14	- 146610.779	- 53503.816		
6-5	- 146605.919	- 53514.934	+ 10996.086904	+ 12732.273586
6-15	- 146579.595	- 53503.397	+ 9148.171730	+ 10951.706843
S5	- 146581.210	- 53500.474	+ 8396.870370	+ 7997.228030
S6	- 146581.723	- 53499.696	+ 8211.036702	+ 8096.312160
S7	- 146585.475	- 53496.699	+ 8521.515600	+ 7902.532377
6-16	- 146589.468	- 53494.462	+ 8651.466132	+ 8074.139450
6-14	- 146610.779	- 53503.816	+ 10464.405898	+ 9288.209888
			+ 64389.553336	+ 65042.402334
		倍面積	= 652.848998	
		面積	= 326.424499	

3 LOT

点 名	X	Y	(X-X0)*(YN-1-Y0)	(XN-1-X0)*(Y-Y0)
X0・Y0	- 146500.000	- 53400.000		
6-8	- 146615.617	- 53492.750		
6-14	- 146610.779	- 53503.816	+ 10274.752250	+ 12002.894472
6-16	- 146589.468	- 53494.462	+ 9288.209888	+ 10464.405898
S8	- 146589.721	- 53494.320	+ 8475.225102	+ 8438.621760
S9	- 146596.141	- 53492.162	+ 9068.019120	+ 8268.866802
S10	- 146598.825	- 53491.088	+ 9107.909650	+ 8757.291408
S11	- 146608.713	- 53487.925	+ 9902.449744	+ 8689.188125
S12	- 146613.905	- 53486.313	+ 10015.097125	+ 9383.345169
6-10	- 146614.700	- 53486.093	+ 9900.101100	+ 9806.423165
6-9	- 146615.810	- 53489.734	+ 9970.430330	+ 10292.489800
6-8	- 146615.617	- 53492.750	+ 10374.775878	+ 10741.377500
			+ 96376.970187	+ 96844.904099
		倍面積	= 467.933912	
		面積	= 233.966956	

\* \* \* \* \* 各 筆 面 積 計 算 書 \* \* \* \* \*

4 LOT

点 名	X	Y	(X-X0)*(YN-1-Y0)	(XN-1-X0)*(Y-Y0)
X0-Y0	- 146600.000	- 53400.000		
6-12	- 146620.944	- 53486.316		
6-4	- 146618.383	- 53486.422	+ 1586.747028	+ 1810.022368
6-8	- 146615.617	- 53492.750	+ 1349.652374	+ 1705.023250
6-9	- 146615.810	- 53489.734	+ 1466.377500	+ 1401.375878
6-10	- 146614.700	- 53486.093	+ 1319.089800	+ 1361.130330
S13	- 146615.303	- 53485.926	+ 1317.481179	+ 1263.112200
S14	- 146617.148	- 53486.030	+ 1473.459048	+ 1316.517090
S15	- 146618.565	- 53485.608	+ 1597.146950	+ 1468.005984
S16	- 146618.315	- 53484.112	+ 1567.910520	+ 1561.539280
6-11	- 146618.477	- 53484.602	+ 1554.137424	+ 1549.485630
6-12	- 146620.944	- 53486.316	+ 1771.904288	+ 1594.860732
			+ 15003.906111	+ 15031.072742
	倍面積	=	27.166631	
	面積	=	13.583315	

5 LOT

小寺2014番

点 名	X	Y	(X-X0)*(YN-1-Y0)	(XN-1-X0)*(Y-Y0)
X0-Y0	- 146600.000	- 53400.000		
6-13	- 146646.375	- 53453.311		
6-2	- 146649.057	- 53482.989	+ 2615.277727	+ 3848.614875
6-3	- 146647.068	- 53485.232	+ 3906.126252	+ 4181.226224
6-12	- 146620.944	- 53486.316	+ 1785.099008	+ 4062.721488
6-11	- 146618.477	- 53484.602	+ 1594.860732	+ 1771.904288
S16	- 146618.315	- 53484.112	+ 1549.485630	+ 1554.137424
S17	- 146617.477	- 53481.526	+ 1470.025424	+ 1493.148690
S18	- 146613.818	- 53469.695	+ 1126.526268	+ 1218.059515
S19	- 146612.786	- 53465.993	+ 891.120270	+ 911.891274
S20	- 146611.639	- 53460.940	+ 768.092527	+ 779.178840
S21	- 146611.120	- 53457.552	+ 677.652800	+ 669.847728
6-17	- 146610.971	- 53456.510	+ 631.402992	+ 628.391200
6-13	- 146646.375	- 53453.311	+ 2620.651250	+ 584.874981
			+ 19636.320880	+ 21703.996527
	倍面積	=	2067.675647	
	面積	=	1033.837823	

6 LOT

点 名	X	Y	(X-X0)*(YN-1-Y0)	(XN-1-X0)*(Y-Y0)
X0-Y0	- 146600.000	- 53400.000		
6-17	- 146610.971	- 53456.510		
S22	- 146610.732	- 53454.838	+ 606.465320	+ 601.627698
S23	- 146611.344	- 53446.936	+ 622.082272	+ 503.717152

\* \* \* \* \* 各 筆 面 積 計 算 書 \* \* \* \* \*

点 名	X	Y	(X-X0)*(YN-1-Y0)	(XN-1-X0)*(Y-Y0)
S24	- 146613.777	- 53445.937	+ 646.637272	+ 521.109328
S24-1	- 146615.902	- 53445.251	+ 730.490174	+ 623.423027
S24-2	- 146621.591	- 53443.948	+ 977.014341	+ 698.861096
S25	- 146645.026	- 53438.175	+ 1978.802648	+ 824.236425
6-1	- 146645.039	- 53438.527	+ 1719.363825	+ 1734.716702
6-13	- 146646.375	- 53453.311	+ 1786.689625	+ 2401.074129
6-17	- 146610.971	- 53456.510	+ 584.874981	+ 2620.651250
			+ 9652.420458	+ 10529.416807
		倍面積 =	876.996349	
		面積 =	438.498174	

6-1, 6-2 (=分割)

\* \* \* \* \* 6-6-1 LOT

面積計算書

\* \* \* \* \* NO 1

点名	X	DX	DMD.1	Y	DY	DMD.2	DX * DMD.2	DY * DMD.1
6-19	- 146629.896			- 53441.902				
S25	- 146645.026	+ 15.130	+ 15.130	- 53438.175	- 3.727	- 3.727	- 56.389510	- 56.389510
6-1	- 146645.039	+ 0.013	+ 30.273	- 53438.527	+ 0.352	- 7.102	+ 0.092326	+ 10.656096
6-13	- 146646.375	+ 1.336	+ 31.622	- 53453.311	+ 14.784	+ 8.034	+ 10.733424	+ 467.499648
6-18	- 146631.052	- 15.323	+ 17.635	- 53454.696	+ 1.385	+ 24.203	+ 370.862569	+ 24.424475
6-19	- 146629.896	- 1.156	+ 1.156	- 53441.902	- 12.794	+ 12.794	- 14.789864	- 14.789864
		+ 16.479			+ 16.521		+ 10.733424	+ 502.580219
		- 16.479			- 16.521		- 442.134269	- 71.179374
							- 431.400845	+ 431.400845

面積 = 215.700422

$438.49 - 222.80 = 215.69 \text{ m}^2 \approx 73$

\* \* \* \* \* 6-6-2 LOT

面積計算書

\* \* \* \* \* NO 1

点名	X	DX	DMD.1	Y	DY	DMD.2	DX * DMD.2	DY * DMD.1
6-17	- 146610.971			- 53456.510				
S22	- 146610.732	- 0.239	- 0.239	- 53454.838	- 1.672	- 1.672	+ 0.399608	+ 0.399608
S23	- 146611.344	+ 0.612	+ 0.134	- 53446.936	- 7.902	- 11.246	- 6.882552	- 1.058868
S24	- 146613.777	+ 2.433	+ 3.179	- 53445.937	- 0.999	- 20.147	- 49.017651	- 3.175821
S24-1	- 146615.902	+ 2.125	+ 7.737	- 53445.251	- 0.686	- 21.832	- 46.393000	- 5.307582
S24-2	- 146621.591	+ 5.689	+ 15.551	- 53443.948	- 1.303	- 23.821	- 135.517669	- 20.262953
6-19	- 146629.896	+ 8.305	+ 29.545	- 53441.902	- 2.046	- 27.170	- 225.646850	- 60.449070
6-18	- 146631.052	+ 1.156	+ 39.006	- 53454.696	+ 12.794	- 16.422	+ 18.983832	+ 499.042764
6-17	- 146610.971	- 20.081	+ 20.081	- 53456.510	+ 1.814	- 1.814	+ 36.426934	+ 36.426934
		+ 20.320			+ 14.608		+ 36.826542	+ 535.869306
		- 20.320			- 14.608		- 482.441554	- 90.254294
							- 445.615012	+ 445.615012

面積 = 222.807506

\* \* \* 各筆面積 集計表 \* \* \*

街区名・筆名	各筆面積	隅切面積
6 BLOCK	2565.62	
1 LOT	519.31	
2 LOT	326.42	
3 LOT	233.96	
4 LOT	13.58	
5 LOT	1033.83	
6-1LOT	<del>438.49</del>	<del>215.70</del> 215.69
6-2LOT		222.80
合計 =	2565.59	0.00